

# Saint Louis Zoo



2026 Investment in Infrastructure Expo

February 24, 2026

Candace Bingham, CSDP

Director of Procurement and Supplier Engagement

# Meet The Saint Louis Zoo Team



**Michael Macek**  
Saint Louis Zoo  
Executive Director



**Andrew Marti**  
Vice President of  
Facilities and Planning



**Glen Donjon**  
Assistant Director  
Facilities Management



**David McGuire AIA,**  
Senior Architect



**Tom Sehnert**  
Maintenance Director



**Wanda Kolo**  
Director of Sustainability and  
Construction Management



**Marta Comas**  
CAD Technician



**Candace Bingham, CSDP**  
Director of Procurement  
& Supplier Engagement

# Centralized eProcurement Platform

**bidnet direct.**  
by SOVRA

 <h2>Saint Louis Zoo Bid Opportunities</h2> <p>Saint Louis Zoo's Open and Closed Solicitations are posted below. Please <a href="#">register</a> or <a href="#">login</a> to see details of all open opportunities.</p> <p><b>Vendor Registration Instructions</b></p> <p>The Saint Louis Zoo utilizes this procurement system to post solicitation opportunities. We welcome all vendors to register with the Missouri Purchasing Group. There is <b>NO CHARGE to register</b>, simply follow the registration path and select the "<b>Limited</b>" package, select "<b>Missouri</b>" for your state, enter your information, and select "<b>Finalize the registration</b>". You will receive notifications of matching solicitations and addenda. To receive notifications from other Purchasing Groups or Statewide notifications, select one of the other registration options.</p>	<h3>Register to Bid</h3> <p>Register to do business with Saint Louis Zoo. Join the Missouri Purchasing Group to expand your business with local governments throughout Missouri.</p> <p>Register with the Missouri Purchasing Group to gain access to bids today.</p> <p><a href="#">REGISTER NOW →</a></p>
--	---

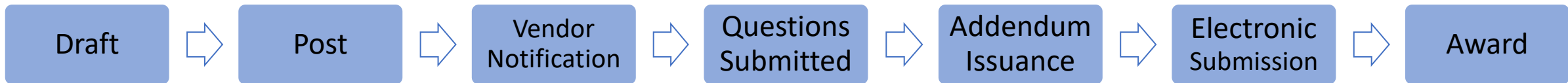

<https://www.bidnetdirect.com/missouri/saintlouiszoo>

# Awarded Bid Process



PROPOSAL  
AMOUNT



TIMELINE &  
IMPLEMENTATION



RELEVANT & PAST  
EXPERIENCE



APPROACH &  
METHODOLOGY



COMPLETENESS  
OF SCOPE

# Project Specific Requirements

Sales Tax Exempt

Contractor  
Controlled  
Insurance Program  
(CCIP)

Subcontractor  
Prequalification

Payment Bonds  
Required-  
Projects over \$50k

Safety Training  
Requirements

Photos/Signage/  
Videos are NOT  
allowed on Zoo  
projects

Prevailing Wage  
Requirements-  
Projects over \$75k

# Capybara Exhibit Updates

- **Project Manager:** Cinnamon Eubanks
- **Estimated bidding:** March 2026
- **Project highlights:** Repairs to the existing pools and associated plumbing, along with habitat regrading and fence installation
- **Trades required:** Plumbing, Fencing, Site grading

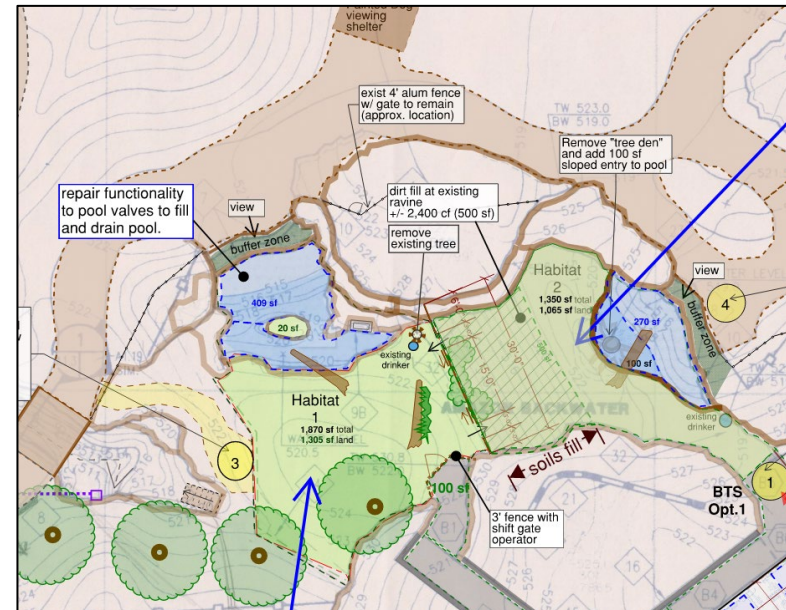

# Digital Display Wayfinding Signage

- **Project Manager:** Greg Linton
- **Estimated bidding:** \$150,000
- **Project highlights:** Addition of digital information and wayfinding signs to Zoo entrances using the interactive map.
  - Two single sided digital signs outside the Zoo.
  - Two double sided digital signs inside the Zoo.
- **Trades required:** Electricians

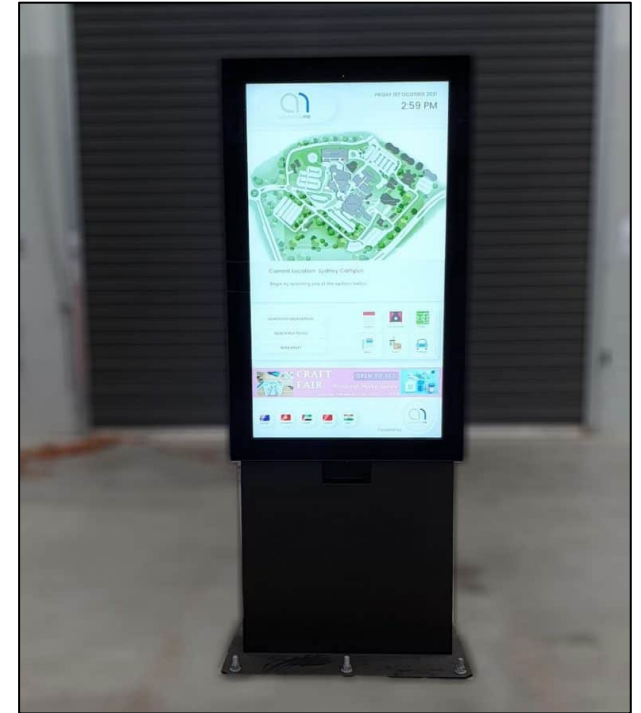

\*For example only. Not product the Zoo intends to use.

# Bayer Insectarium HVAC Replacement

- **Project Manager:** Glen Donjon
- **Estimated bidding:** Mid-March 2026
- **Project highlights:** Installation of new HVAC systems and humidity control to isolate animal space
- **Trades required:** HVAC, Roofing



# North Parking Lot Overlay

- **Project Owner:** Glen Donjon
- **Estimated bidding:** Fall 2026
- **Project highlights:** After the completion of Destination Discovery, this project will focus on the restoration of the parking lot due to the impact of construction.
- **Trades required:** Asphalt Pavers

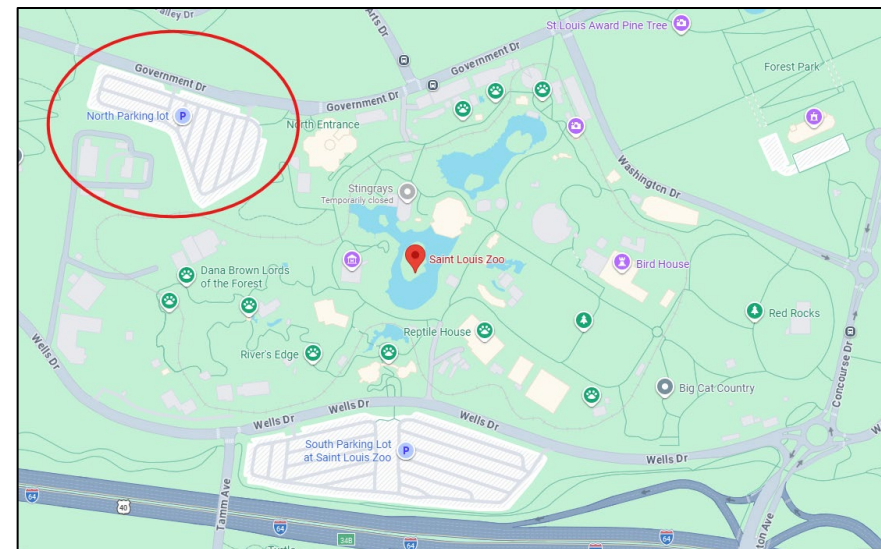

# McDonnell Center River Camp Roof Replacement

- **Project Manager:** Glen Donjon
- **Estimated bidding:** Early March 2026
- **Project highlights:** Complete removal and reinstallation of tapered insulation and TPO membrane.
- **Trades required:** Roofing



# Facilities Management Vendors of Record

- **Project Manager:** Glen Donjon
- **Estimated bidding:** April, May and June 2026
- **Project highlights:** To identify and award the Zoo's preferred Vendors of Record for a 2 year term (option to extend 2 years if mutually agreed upon)
- **Trades required:** Electrical, HVAC- R, Plumbing, Fuel, Fleet, Automatic Door & Gate, Fire Sprinkler & Backflows, Fire Alarm & Devise Texting, Generator, Elevator, Roofing, Fencing, Hazardous Materials, Carpentry, Landscape Management, Rental Equipment, Concrete/Masonry



# Mary Ann Lee Butterfly Wing-Dome Replacement

- **Project Manager:** David McGuire
- **Estimated bidding:** Summer 2026
- **Project highlights:** Replacement of the existing Butterfly Dome
- **Trades required:** General Contractor, HVAC, Electrical, Glaziers, Ironworkers/Metal Stud Framers, Carpentry, Masonry/Shotcrete Contractors, Steeplejacks, Demolition



# Sears Lehmann Jr. Wildlife Reserve



# What is the Wildlife Reserve?

- 355-acre nature sanctuary with 20+ acres devoted to the conservation of the critically endangered American Red Wolf.
- Wolf area includes seven 1-acre naturalistic habitats with chain-link primary and secondary barriers.
- Property is not open to the public.



# Where is the Sears Lehmann Jr. Wildlife Reserve?

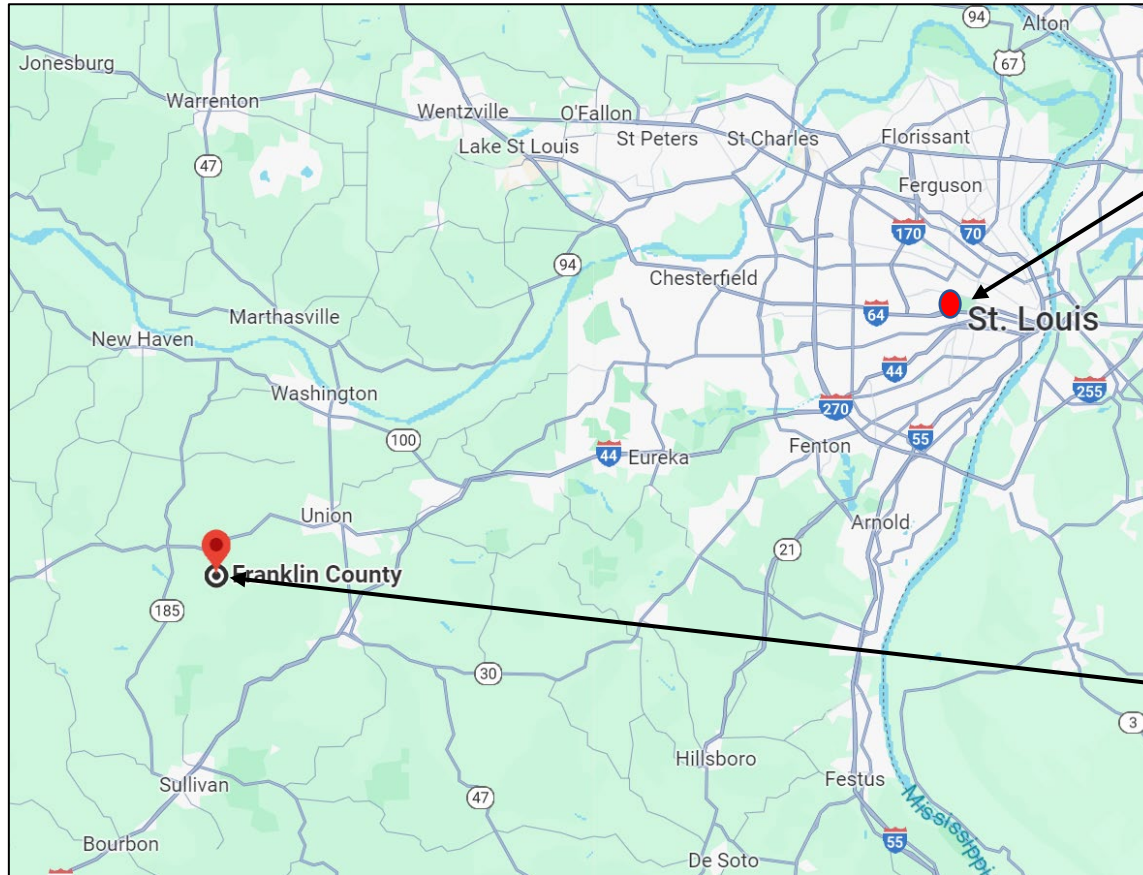

**Saint Louis Zoo**

**About 40 miles southwest from Saint Louis Zoo in Franklin County**

**Sears Lehmann Jr. Wildlife Reserve**

# No Scheduled Projects in 2026



# Saint Louis Zoo WildCare Park



# Meet the WildCare Park Team

Owner:  
Saint Louis Zoo



**Sabarras George**  
WildCare Park Director



**Martha Fischer,**  
MA, MPA  
WildCare Park General  
Curator



**Leslie Garner,**  
AIA, LEED AP BD+C.  
WildCare Park Director  
of Architecture &  
Construction



**Candace Bingham, CSDP**  
Director of Procurement  
& Supplier Engagement

# What is WildCare Park?



Essential conservation institution engaging in research and breeding of endangered species through Conservation and Animal Science Center



Phenomenal guest experience to connect people with animals and nature

# Where is the WildCare Park?

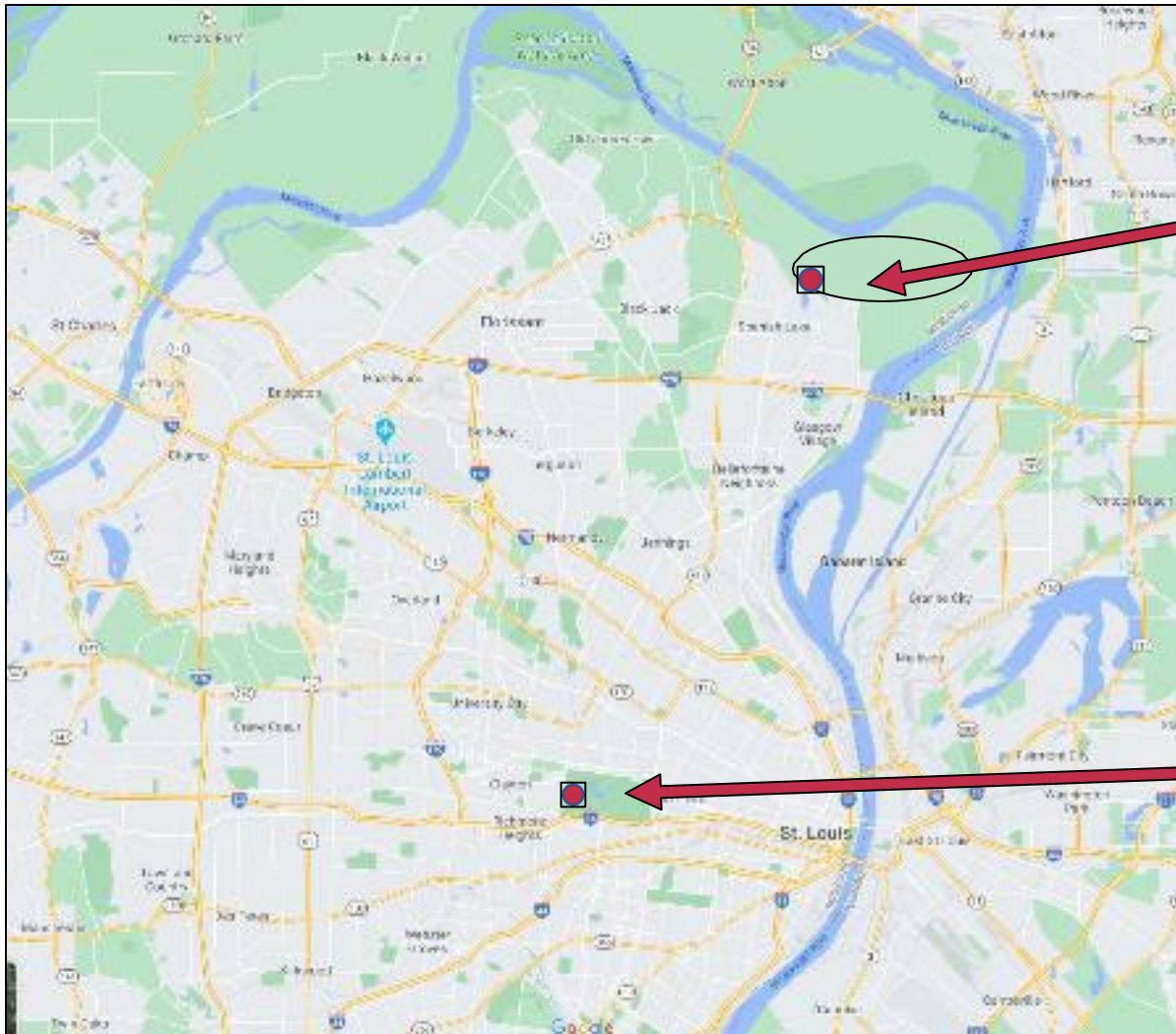

Saint Louis Zoo  
WildCare Park

- About 15 miles from Saint Louis Zoo
- Property near Missouri-Mississippi River Confluence

Saint Louis Zoo

# What are we striving for?

- A WildCare Park that delights guests and functions well for the public, the animals and the people that care for them.
- A Conservation and Animal Science Center that supports species recovery programs and population sustainability.

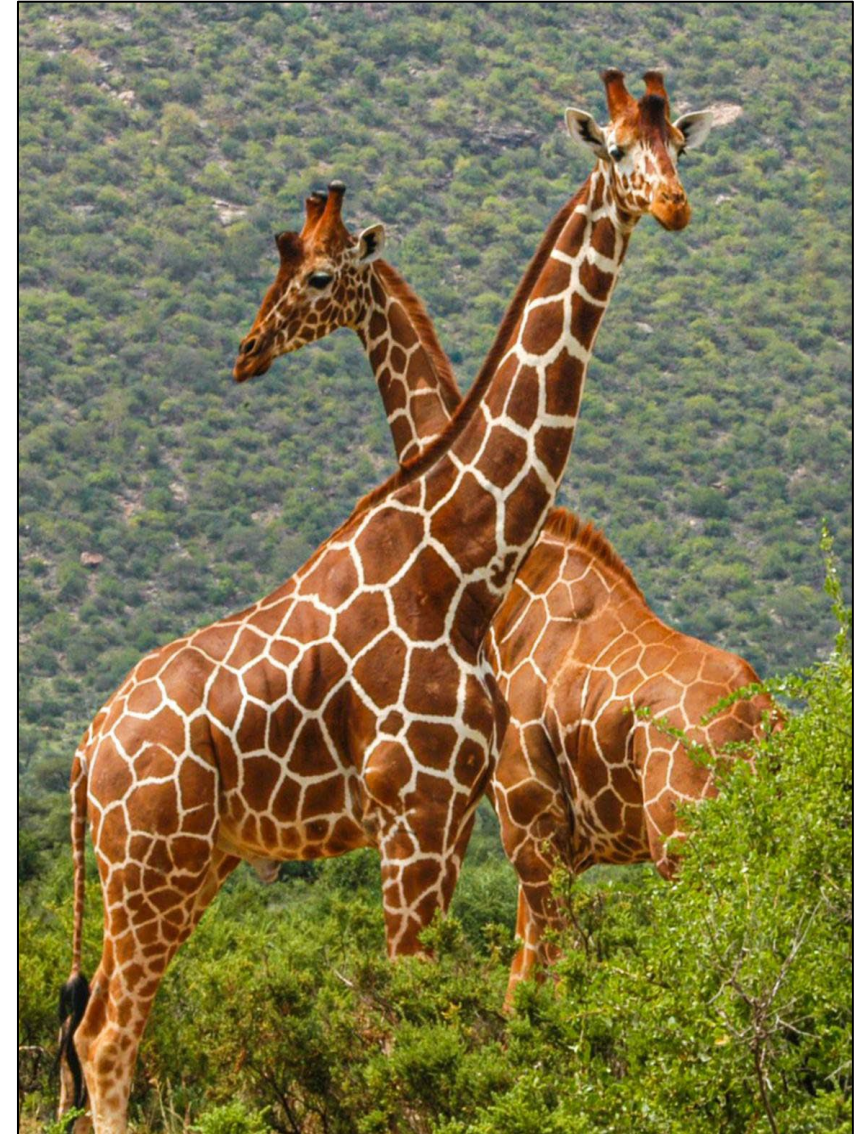



# Components

- Woodland Safari with 2 barns; smaller barn
- Savanna Safari with 4 barns; smaller barn
- 9 Conservation Pastures
- 5 Conservation Barns
- 2 Hay Barns
- Walking Safari
- Restaurant
- Zoo Museum
- Distribution
- Events Center
- Conservation
- Headquarters renovation
- Facilities Management in residential area
- Animal Health Center – treatment and quarantine
- Safari Observation Tower
- 10 Glamping Cabins
- Nature Trail
- North and South Fleet Sheds
- Giraffe Feeding

# High Overview

**SCHEDULED  
PERIOD OF  
PERFORMANCE  
2026 – 2027**

**2026** Major Construction Complete, Animal Acclimation Underway

**2027** Targeted Public Opening







# Key Takeaways



## **Bid Opportunities**

Visit: [stlzoo.org/vendor](http://stlzoo.org/vendor) to register and view bid opportunities

## **Questions?**

Contact:

Candace Bingham, CSDP  
Director of Procurement &  
Supplier Engagement

[cbingham@stlzoo.org](mailto:cbingham@stlzoo.org)

# Thank you

